



### FAST FACTS

- Multicat Vessel
- 140tm crane
- 50ton winch
- 1200hp

### SUMMARY

A multipurpose work boat ideally suited designed for marine construction and offshore works. PMI Tiger is equipped with a 140tm crane and a 50ton winch. These facilities coupled with a large deck space make PMI Tiger an ideal work boat for offshore and marine related construction work. Accommodation quarters onboard can support a crew of 5 personnel

### DETAILS

#### CLASSIFICATION / FLAG

Flag: Togo  
 Trading Area: Coastal Waters < 30nm  
 Call Sign / IMO: 5 V PR 9 / 9395783  
 Classification: Bureau Veritas  
 Class Ship Type: Special Service / Work Boat

Class Notation:

I + HULL \* MACH Special Service / Multipurpose ship coastal area

#### PRINCIPAL DIMENSIONS

Length o.a.: 20.1m  
 Breadth o.a.: 8.04m  
 Draft: 1.77m - 2.35m  
 GRT: 102  
 NRT: 30  
 Max. deck load: 5t/sqm  
 Free deck space: FWD 35sqm AFT 42sqm

#### MACHINERY / PROPULSION

Max Speed: 9 knots  
 Bollard Pull: 14 ton  
 Power Output: 882kW / 1200hp  
 Propulsion: Twin Fixed Pitch Propellers in nozzles  
 Main Engine: Cummins KTA19-M3  
 Marine Gears: ZF Marine ZFW3450  
 Auxiliaries Engines: 440/230 V -97kVA

#### TANK CAPACITIES

Fuel: 40m3  
 Fresh Water: 27m3

#### ACCOMMODATION

Fully air-conditioned, galley, shower/toilet, 2 x double cabins.

#### NAVIGATION/COMMUNICATION

- AIS Furuno FA-1501
- Autopilot Radio Holland Seapilot-75 / Eco 600
- DPGS Furuno GP-90
- Echosounder Furuno FCV-582L
- Epirb Jotron Tron 40 S
- Magnetic compass Radio Holland Reflecta-5
- MF/HF Radiotelephone transceiver Sailor 5000
- Navtex Furuno NX-700
- NMEA Radio Holland RZ-255

- Radar Furuno FR-1505 MK3
- Rudder ang. indicator WK Hydraulics
- Sart Jotron Tronsart
- Satellite compass Furuno SC-50
- VHF control unit Sailor CU5000
- VHF DSC Sailor RT5022
- VHF DSC Sailor RT5022
- VHF GMDSS Jotron Tron TR20

#### MICELLANEOUS

AH/towing winch: 50ton  
 Fresh Water pump: 4.4kW  
 Fuel Pump: 4.4kW  
 Hydraulic Deck Crane: 140tm  
 M/H/ Towing Hook FS: SWL: 15 ton, TL: 30 ton, RL 15 ton  
 M/H/ Towing Hook MS: SWL: 15 ton, TL: 30 ton, RL 15 ton  
 Tugger Winch: 10ton



# PMI

## PMI TIGER MULTICAT VESSEL



(GHA) +233 50 156 9295/6/7    (RSA) +27 21 880 1140    info@pmi-ltd.co.za    Western Africa    www.pmi-ltd.co.za

### LAYOUT DIAGRAMS

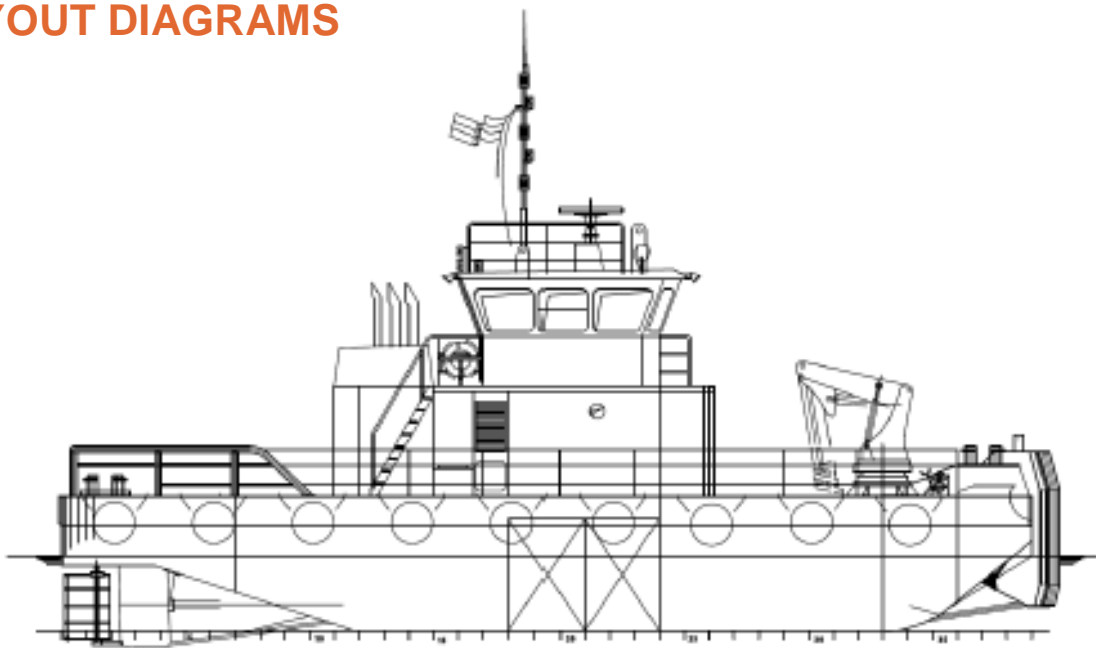

MAINDECK

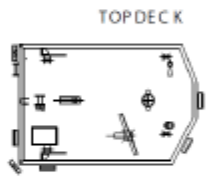
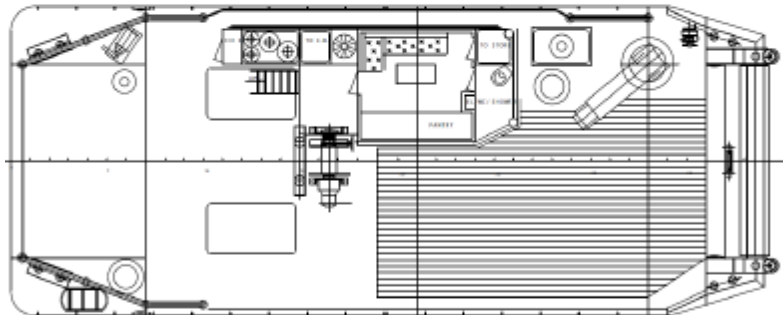
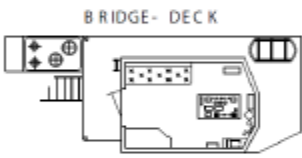

BELOW MAINDECK

